



## 18 Silverdale Terrace, Gateshead, NE8 4JL

**£675**

A Bright and Spacious Home Just Steps from Saltwell Park

Welcome to 18 Silverdale Terrace – a charming ground-floor flat that combines period character with modern living. With generous rooms, a fresh interior, and one of Gateshead's most popular parks right on your doorstep, this is a home you'll love coming back to.

The property features a large open-plan lounge and dining area, filled with natural light from two big windows. The modern kitchen is well-equipped with fitted units, integrated oven, gas hob and plenty of storage space. It also has access to a private rear yard, perfect for relaxing outside or storing bikes and bins neatly.

The spacious double bedroom at the front of the home boasts a lovely bay window and neutral décor, making it an inviting space to unwind. The contemporary bathroom is finished with smart dark tiles, a full-size bath and shower over.

Located in the sought-after Saltwell area, this property is just a short walk from the award-winning Saltwell Park, ideal for morning jogs or peaceful weekend walks. Shops, cafes and public transport links are all



## Floor Plan

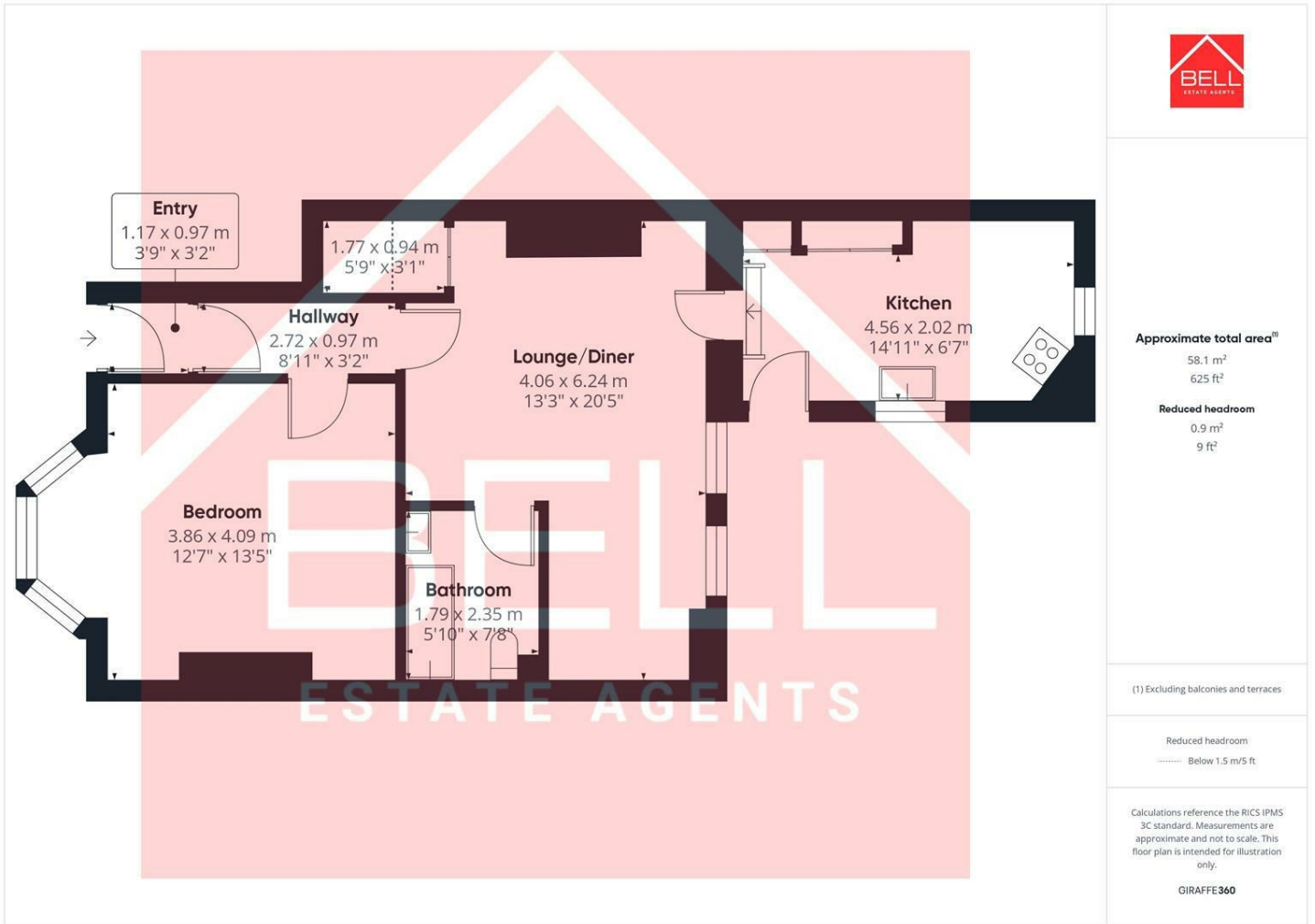

## Area Map



## Energy Efficiency Graph

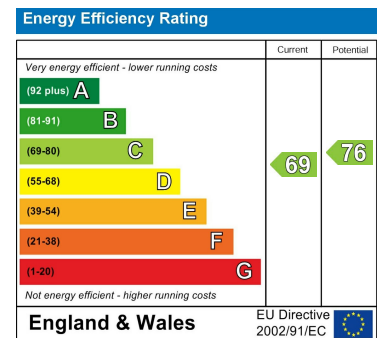

These particulars, whilst believed to be accurate are set out as a general outline only for guidance and do not constitute any part of an offer or contract. Intending purchasers should not rely on them as statements of representation of fact, but must satisfy themselves by inspection or otherwise as to their accuracy. No person in this firm's employment has the authority to make or give any representation or warranty in respect of the property.